

# Thermoplastic Pillow Blocks

## With Eccentric Locking Collar Stainless Steel bearing insert-SNATP

- Overview of corrosion resistant products – pg. 48



B-type Seal

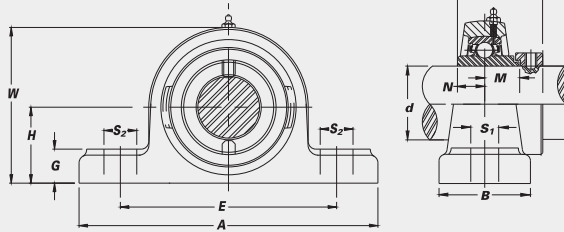

CORROSION RESISTANT

Unit No.	Shaft Dia.		Dimensions (in.) (mm)										Bolt Used (in.)	Bearing No.	Housing No.	Weight (lbs.)	
	<i>d</i>	(in.) (mm)	<i>H</i>	<i>A</i>	<i>E</i>	<i>B</i>	<i>S<sub>2</sub></i>	<i>S<sub>1</sub></i>	<i>G</i>	<i>W</i>	<i>Bi</i>	<i>N</i>					<i>M</i>
<b>SNATP with Stainless Steel Bearing Inserts</b>																	
SNATP 204-12 204	3/4	20	1 5/16 33.3	5 127	3 3/4 95	1 1/2 38	9/16 14	7/16 11	9/16 14	2 19/32 66	1.5433 39.2	0.5000 12.7	0.6693 17.0	3/8	SNA 204-12 204	TP 204	.9
SNATP 205-14 205 205-16	7/8	25	1 7/16 36.5	5 1/2 140	4 1/8 105	1 1/2 38	9/16 14	7/16 11	9/16 14	2 13/16 71	1.6220 41.2	0.5630 14.3	0.6850 17.4	3/8	SNA 205-14 205 205-16	TP 205	.9
SNATP 206 206-19 206-20	1 3/16 1 1/4 S	30	1 11/16 42.9	6 13/32 163	4 11/16 119	1 13/16 46	23/32 18	9/16 14	1 1/16 18	3 19/64 84	1.8110 46.0	0.6260 15.9	0.7165 18.2	1/2	SNA 206 206-19 206-20	TP 206	1.3
SNATP 207-20 207-22 207 207-23	1 1/4 1 3/8 1 7/16	35	1 7/8 47.6	6 5/8 168	5 127	1 29/32 48	23/32 18	9/16 14	1 1/16 18	3 11/16 94	1.9606 49.8	0.6890 17.5	0.7402 18.8	1/2	SNA 207-20 207-22 207 207-23	TP 207	1.9
SNATP 208-24 208	1 1/2	40	1 15/16 49.2	7 1/4 184	5 7/16 137	2 1/8 54	23/32 18	9/16 14	25/32 20	3 29/32 99	2.1220 53.9	0.7480 19.0	0.8425 21.4	1/2	SNA 208-24 208	TP 208	2.4