

# Thermoplastic Pillow Blocks

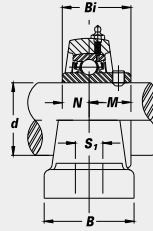
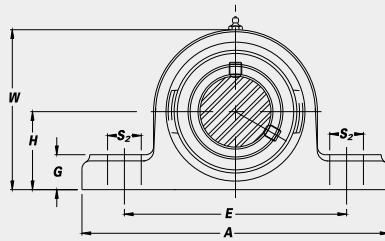

## With Set Screw Lock

Optional bearing inserts:  
**Stainless Steel-SUCTP**  
**Hard Chrome Coated-CUCTP**  
**Black Oxide-BUCTP**

• End Caps Available for all styles.

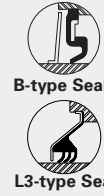

B-type seal available in all styles and sizes.

L3-type seal available in SUC units only. Limited sizes. Consult IPTCI for speed limitations.

CORROSION RESISTANT

Unit No.	Shaft Dia.		Dimensions (in.) (mm)										Bolt Used (in.)	Bearing No.	Housing No.	Weight (lbs.)
	d (in.)	d (mm)	H	A	E	B	S <sub>2</sub>	S <sub>1</sub>	G	W	Bi	N				

### SUCTP with Stainless Steel Bearing Inserts

SUCTP 201-8	1/2														SUC 201-8		
202-10	5/8														202-10		
204-12	3/4														204-12		
204		20	33.3	127	95	38	14	11	14	66	31.0	12.7	18.3	3/8	TP 204		.8
SUCTP 205-14	7/8														SUC 205-14		
205		25	36.5	140	105	38	14	11	14	71	34.0	14.3	19.7	3/8	TP 205		.8
205-16	1														205-16		
SUCTP 206-18	1 1/8														SUC 206-18		
206		30	42.9	163	119	46	18	14	18	84	38.1	15.9	22.2	1/2	TP 206		1.2
206-19	1 3/16														206-19		
206-20	1 1/4														206-20		
SUCTP 207-20	1 1/4														SUC 207-20		
207-21	1 5/16														207-21		
207-22	1 3/8														207-22		
207		35	47.6	168	127	48	18	14	18	94	42.9	17.5	25.4	1/2	TP 207		1.7
207-23	1 7/16														207-23		
SUCTP 208-24	1 1/2														SUC 208-24		
208		40	49.2	184	137	54	18	14	20	99	49.2	19.0	30.2	1/2	TP 208		2.2

### CUCTP with Hard Chrome Coated Bearing Inserts

CUCTP 204-12	3/4														CUC 204-12		
204		20	33.3	127	95	38	14	11	14	66	31.0	12.7	18.3	3/8	TP 204		.8
CUCTP 205-14	7/8														CUC 205-14		
205		25	36.5	140	105	38	14	11	14	71	34.0	14.3	19.7	3/8	TP 205		.8
205-16	1														205-16		
CUCTP 206-18	1 1/8														CUC 206-18		
206		30	42.9	163	119	46	18	14	18	84	38.1	15.9	22.2	1/2	TP 206		1.2
206-19	1 3/16														206-19		
206-20	1 1/4														206-20		
CUCTP 207-20	1 1/4														CUC 207-20		
207-22	1 3/8														207-22		
207		35	47.6	168	127	48	18	14	18	94	42.9	17.5	25.4	1/2	TP 207		1.7
207-23	1 7/16														207-23		
CUCTP 208-24	1 1/2														CUC 208-24		
208		40	49.2	184	137	54	18	14	20	99	49.2	19.0	30.2	1/2	TP 208		2.2

### BUCTP with Black Oxide Bearing Inserts

BUCTP 201-8	1/2														BUC 201-8		
202-10	5/8														202-10		
204-12	3/4														204-12		
204		20	33.3	127	95	38	14	11	14	66	31.0	12.7	18.3	3/8	TP 204		.8
BUCTP 205-14	7/8														BUC 205-14		
205		25	36.5	140	105	38	14	11	14	71	34.0	14.3	19.7	3/8	TP 205		.8
205-16	1														205-16		
BUCTP 206-18	1 1/8														BUC 206-18		
206		30	42.9	163	119	46	18	14	18	84	38.1	15.9	22.2	1/2	TP 206		1.2
206-19	1 3/16														206-19		
206-20	1 1/4														206-20		
BUCTP 207-20	1 1/4														BUC 207-20		
207-22	1 3/8														207-22		
207		35	47.6	168	127	48	18	14	18	94	42.9	17.5	25.4	1/2	TP 207		1.7
207-23	1 7/16														207-23		
BUCTP 208-24	1 1/2														BUC 208-24		
208		40	49.2	184	137	54	18	14	20	99	49.2	19.0	30.2	1/2	TP 208		2.2